



Installation Guide

C Max Impact

Robo Clip Impact Tile Restraint

YOU WILL NEED

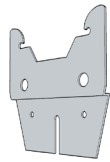

ROBO CLIPS

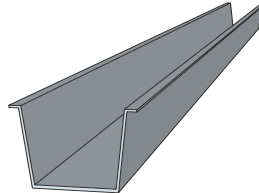

16 OR 28mm FURRING CHANNEL

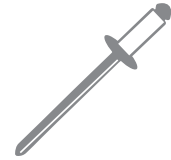

RIVET FIXINGS (73AS4-2)

step 1

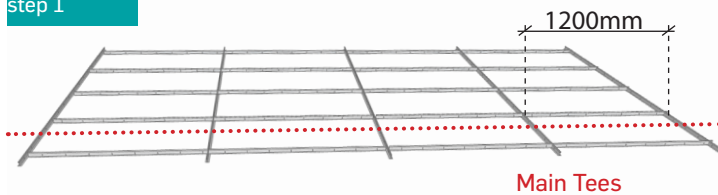

Main Tees

step 2

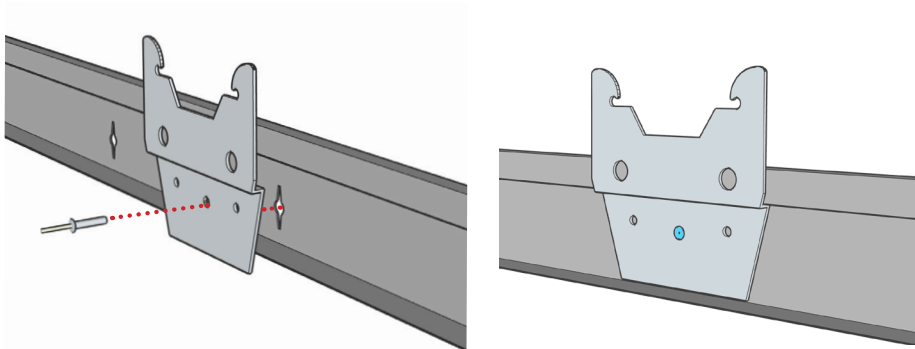

step 3

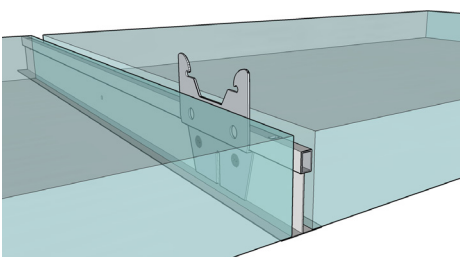

step 4

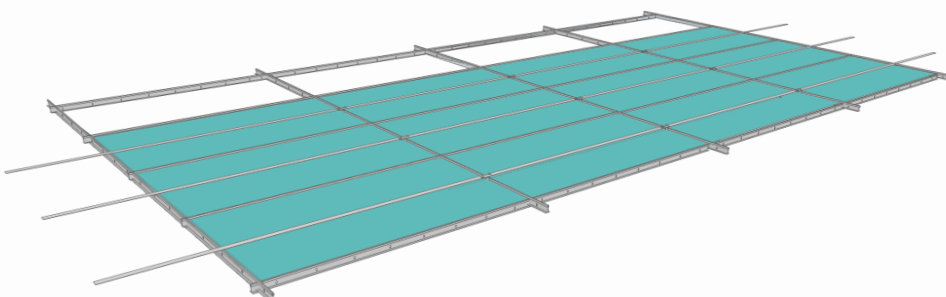
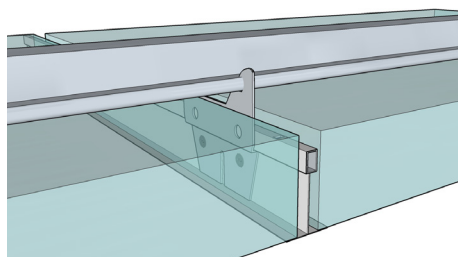

step 1

Install two way exposed ceiling grid as per manufacturers' specifications.

The restraints will be added one row at a time and should ideally **run perpendicular to the main tees** (so that the furring channel restraint is fixed at 1200mm centres and the Robo Clip fixings are attached to main tees). See drawing for orientation.

step 2

Start at either end of a row and place the Robo Clip onto the main tee equidistant between the cross tees (300mm from each). Line up the central hole in the robo clip with the pre-punched holes in the grid. Ensure a good fit and rivet into place. Repeat on every main tee so that the Robo clips create a straight line through the middle of each tile space.

step 3

Insert tiles into the grid. They will fit snugly around the robo clips and rivets.

step 4

Through the opening from an adjacent row, click lengths of furring channel into the top of the Robo Clip to prevent the tile from lifting during any impact from below

step 5

Repeat throughout ceiling grid. Please note that the last perimeter row cannot be clipped.

Please note: Once tiles have been put into place they cannot be removed. If access is required, please designate service tiles (without clips) or use access hatches.